

CF Elbow 90

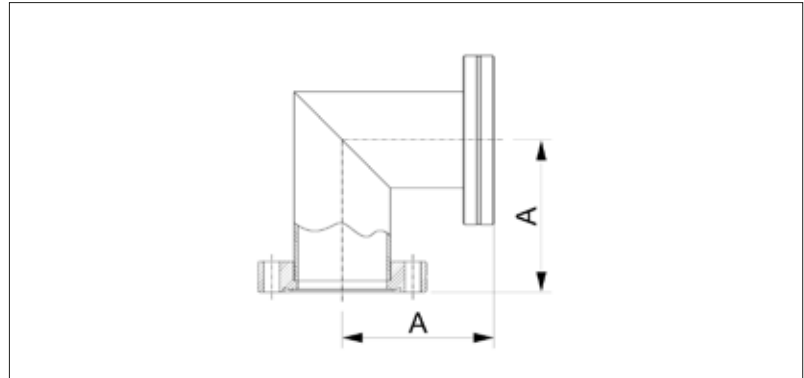

- One end fixed and one end rotatable flanges
- Pressure range: $1 \cdot 10^{-12}$ mbar to ambient pressure
- Custom lengths available upon request
- Tube surface: Glass bead blasted (polished version on request)
- Tightness: $\leq 1 \cdot 10^{-10}$ mbar l/s
- Bake out range is up to 450°C

Dimensions



Stainless Steel 304/1.4301

- Temperature range: -196 to 300 °C
- Flange material: SS304 / 1.4301
- Tube material: SS304 / 1.4301

Flange Size (DN)	A (mm)	Order No
16	38	VC4FTD1SS016-90-38
40	63	VC4FTD1SS040-90-63
63	105	VC4FTD1SS063-90-105
100	135	VC4FTD1SS100-90-135
160	167	VC4FTD1SS160-90-167

Stainless Steel 316L/1.4404

- Temperature range: -196 to 350 °C
- Flange material: SS316L / 1.4404
- Tube material: SS316L / 1.4404

Flange Size (DN)	A (mm)	Order No
16	38	VC4FTD2SS016-90-38
40	63	VC4FTD2SS040-90-63
63	105	VC4FTD2SS063-90-105
100	135	VC4FTD2SS100-90-135
160	167	VC4FTD2SS160-90-167